

## ACOUSTIC PERFORMANCE

IMPACT L<sub>n</sub>TW = 55dB    AIRBORNE D<sub>n</sub>TW = 50dB    D<sub>n</sub>TW + CTR = 48dB

RESULTS ARE BASED ON ALL HUSH COMPONENTS BEING USED WITHIN THE HD1048 SYSTEM AND INSTALLED AS PER THE INSTALLATION GUIDES. ALL FLANKING PATHS TO BE TREATED CORRECTLY.

## SPECIFICATION

HUSH MAT 15 TO BE BONDED TO THE TIMBER STRUCTURE USING THE HUSH CONTACT ADHESIVE. SUITABLE FLOOR FINISHES CAN THEN BE INSTALLED OVER THE HUSH MAT 15 WITH THE CORRECT INSTALLATION GUIDANCE. THE TIMBER DECK OVER THE JOISTS CAN BE THE ORIGINAL FLOORBOARDS OR A 18mm / 22mm T&G CHIPBOARD / PLYWOOD DECK.

INSTALL THE HUSH-MF SYSTEM TO THE UNDERSIDE OF THE JOISTS CREATING A MINIMUM 150mm VOID FROM THE UNDERSIDE OF THE JOISTS TO THE BACK OF THE PLASTERBOARD LINING. INSTALL THE HUSH SLAB 100 SOUND ABSORBER TIGHTLY TOGETHER WITHIN THE CEILING VOID.

INSTALL A DOUBLE PLASTERBOARD LAYER TO THE UNDERSIDE OF THE HUSH-MF SYSTEM. THE PLASTERBOARD LINING SHOULD CONSIST OF 19mm PLASTERBOARD PLANK AND 12.5mm SOUNDBLOC. SEAL ALL PERIMETERS WITH THE HUSH ACOUSTIC SEALANT PRIOR TO SKIMMING.

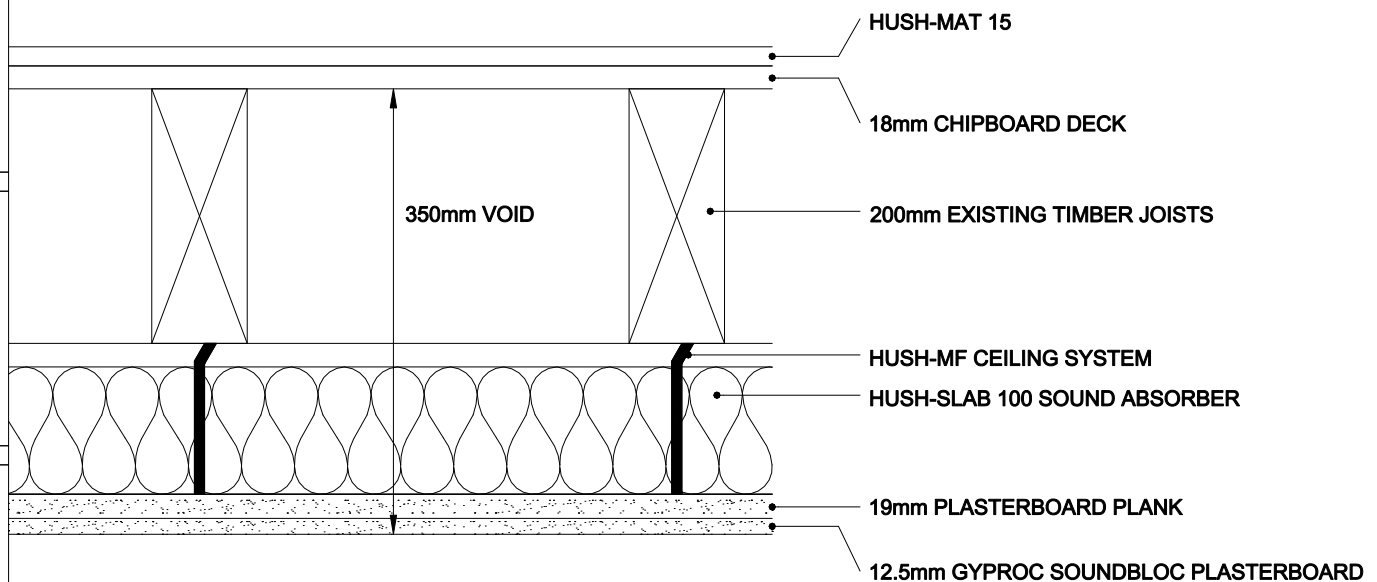

HUSH (UK) LTD  
HUSH-MAT 15 MF SYSTEM  
HD1048